

SALES DRAWING

SALES DRAWING

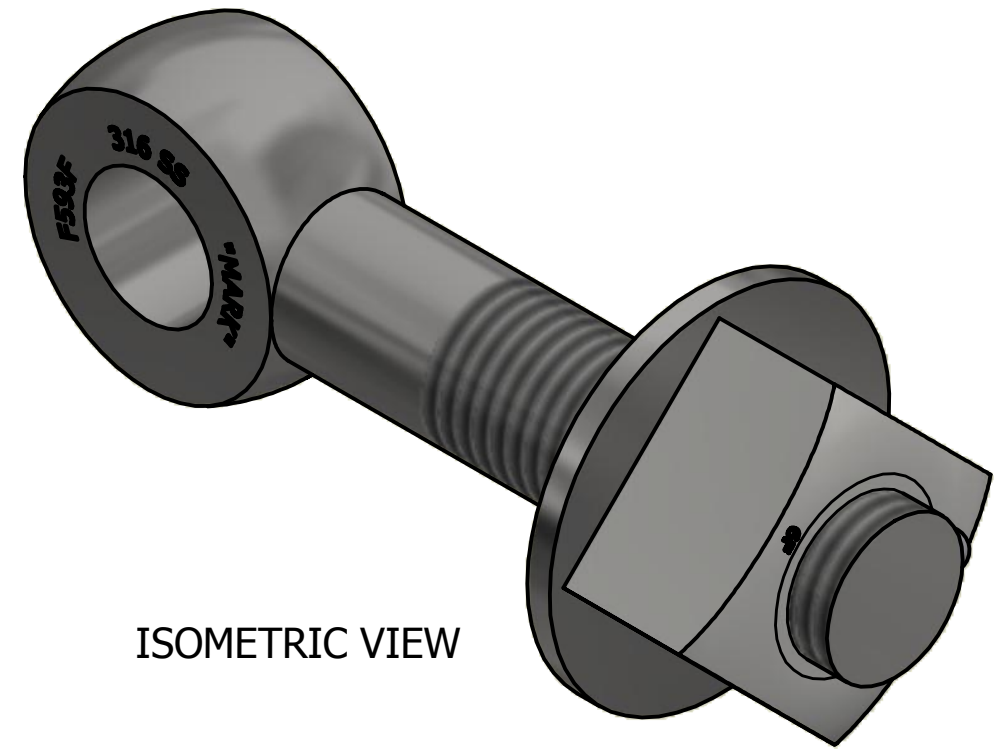
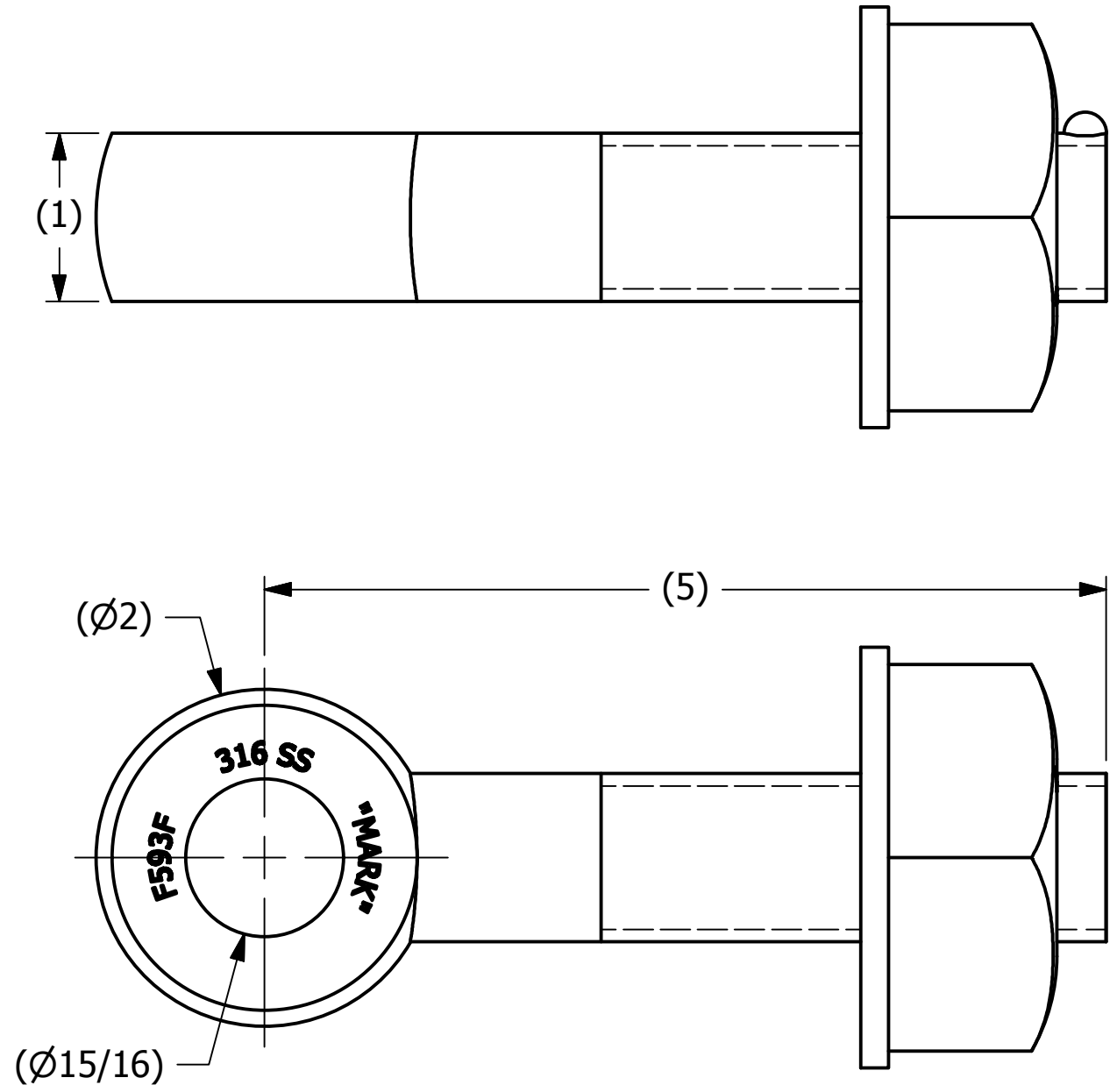

ISOMETRIC VIEW

REV	BY	DATE	DESCRIPTION
F	WEB	4-10-19	UPDATED VIEW TO SHOW MATERIAL MARKING; UPDATED TITLEBLOCK
E	CHL	6-27-07	REMOVED "W" FROM PART NUMBER
D	FOD	5-24-99	CHANGED PART NAME DESCRIPTION
C	FOD	5-3-99	UPDATE TOP VIEW
B	FOD	4-19-99	CHANGED EYEBOLT WAS EBR15S6W
A	FOD	3-17-99	PLACED NOTE

<small>UNLESS OTHERWISE SPECIFIED DIMENSIONAL TOLERANCES</small> FRACTIONAL: ±1/16 X.XX: ±.03 X.XXX: ±.015 ANGULAR: ±1° <small>DEBURR ALL SHARP EDGES. ALL MACHINED SURFACES TO HAVE A 125 RMS FINISH UNLESS NOTED OTHERWISE.</small>	DRAWN BY:	FOD
	CHECKED BY:	SAB
	PROTOTYPE BY:	FOD
	PROTOTYPE DATE:	3/15/1999
<small>THIRD ANGLE PROJECTION</small> 	APPROVED FOR PRODUCTION BY:	SAB
	PRODUCTION DATE:	3/15/1999

PART NAME: EYEBOLT ASSEMBLY 1"X5"		
MATERIAL: STAINLESS STEEL		
PROJECT #: 990304	SHEET #: 1 OF 1	SCALE: 1:1
DRAWING #: B13264	PART #: EB15AS6	

THIS PRINT, PROPERTY OF SALCO PRODUCTS INC., CONTAINS PROPRIETARY INFORMATION AND MUST NOT BE COPIED, REPRODUCED, OR USED DETRIMENTALLY TO OUR INTEREST.